

The iPAD SP2

Automatic External Defibrillator



Overview

Key Features



Compact. Robust. Lightweight.

The iPAD SP2 is designed for durability. It is drop tested from 1.2m upon any surface, on all corners. It is also water and dust proof (IP55).

It can operate between 0°C —50°C and meets all standard vibration tests (MILSTD 810G).



Disposable Adult/Child Smart Electrode Pads

Adult/Child "Smart" Pads, capable of 'talking' to the device to notify users of expired defibrillator pads and if the pads have already been used.

These pads are useable with paediatric patients by simply selecting adult or child soft key. In AED mode, these pads can be used on infants down to 1 years old.

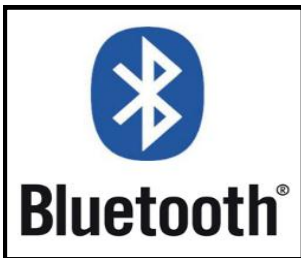

Bluetooth Technology

The iPAD SP2 is designed to be future proof, providing industry standard technologies for high performance during rescue situations. The Bluetooth printer and ECG module allow for remote monitoring (up to 10 metres) and on the spot reporting— by the casualty's side or on the move.



Manual Override

Gives trained healthcare professionals the opportunity to interpret select the appropriate energy level and delivery a shock manually. The low energies available under manual mode allow for infants under the age of 1 to be shocked.



Full colour screen

The colour screen allows for significant amounts of clinical data to be available at your fingertips. The indicators (see LCD Monitor section) provide up to date information on the patient through either lead II (via defibrillation pads) or via the 3 Lead ECG module. It will also clearly show modes (AED/ Manual/Monitoring) and patient modes (Adult/Paediatric).



Event review and playback

The 'review' function allows for recorded events to be replayed on the colour screen with the option to print out a partial or full readout from the Bluetooth printer.



Ambient Noise Detector

When the environment is loud, the iPAD SP2 automatically senses this and increases it's own volume to ensure the rescuer can hear audible commands clearly and precisely. If preferred, the volume can be manually controlled.



Multifunctioning soft keys

User friendly interface to be able to set up and change modes and settings quickly. They are inset from the body of the unit to prevent accidental pressing or knocking.

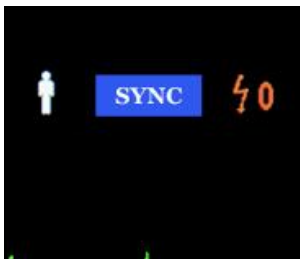

Synchronized cardioversion

A feature normally only available on high end equipment.

SP2 Layout

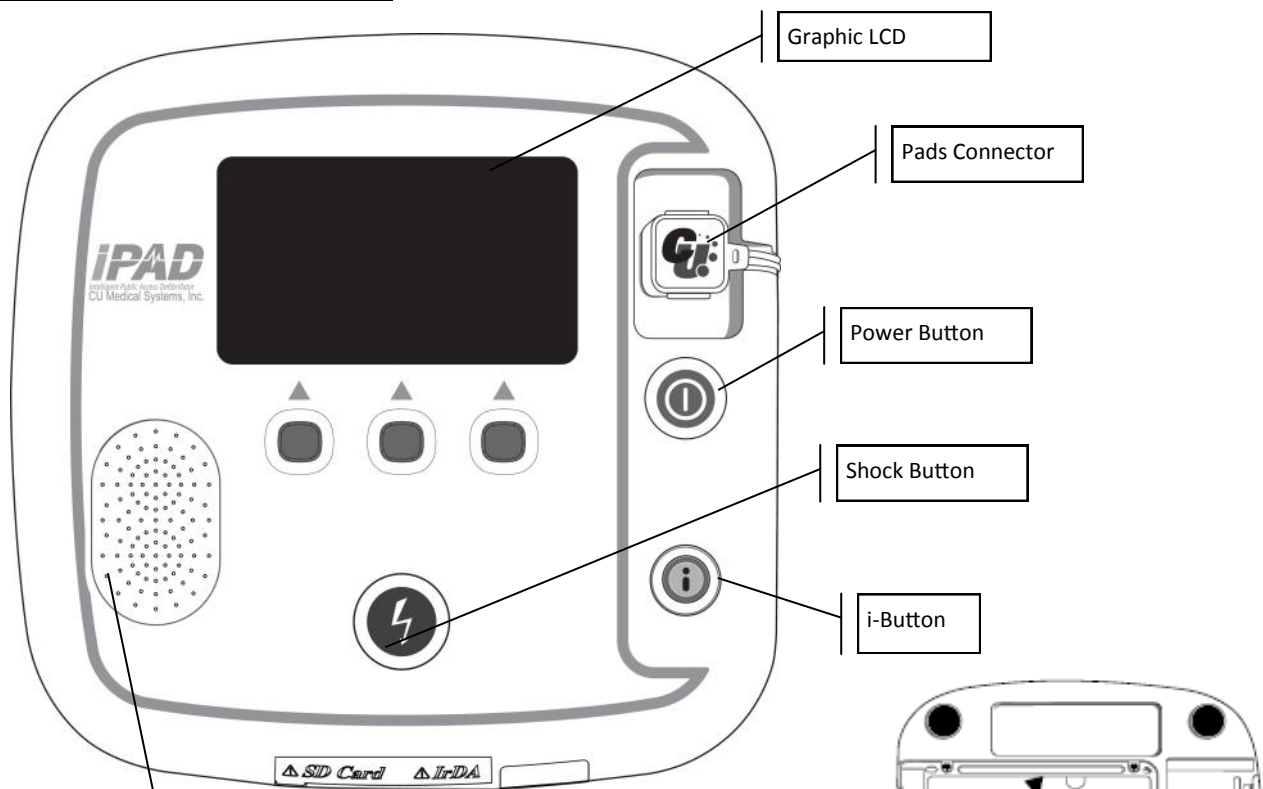

Speaker:

Ambient noise detector measures level of background noise and adjusts the volume of the voice prompts accordingly.

Ideal for noisy environments such as public places, factories, warehouses, schools etc.

Smart Pads Storage:

- Electrode pads are stored, pre-connected, in a clear compartment on the underside of the unit.

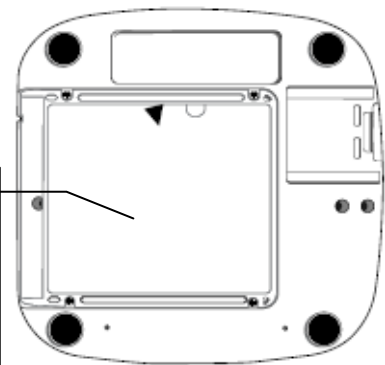

Data Transfer

With an infrared port and SD Card slot, the SP2 can transfer rescue data for analysis after an event.

Battery Pack

(See Power Options page)

Soft Key Button

For easy inter-changeable settings and menus. They are inset to prevent accidentally changing.

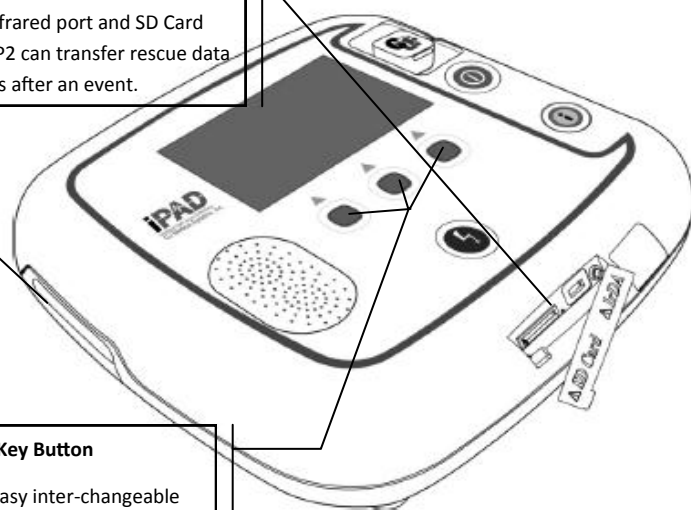

Bluetooth Technology



Bluetooth®

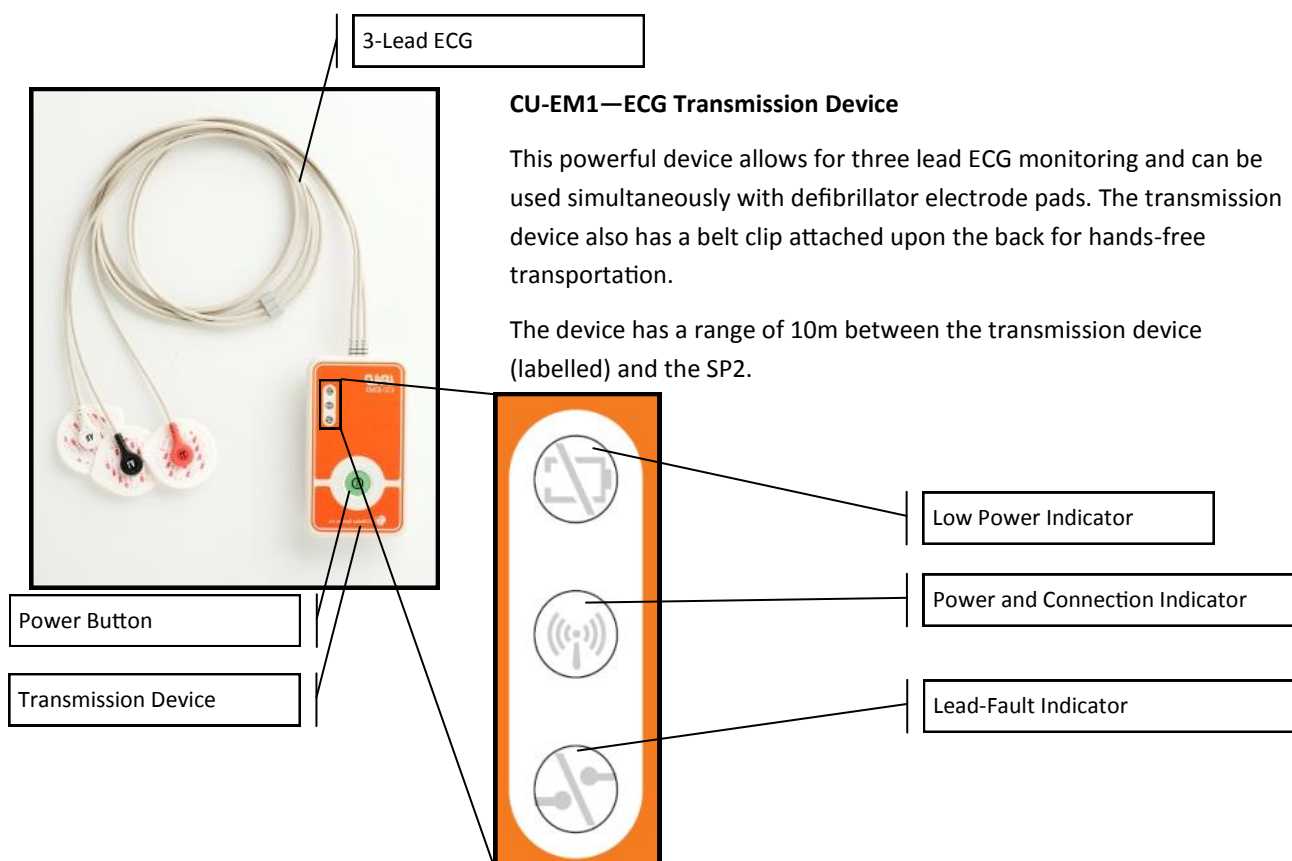

Bluetooth ECG Printer

This rechargeable printer offers a method of immediately providing a permanent record of the event. With a meter to allow you to check the current charge left in the device, a manual feed option as well as an error status indicator which will allow you to know if there's any fault with the printer.

The paper used on this device is also compatible with the other CU Medical products (HD1 and ER Ranges).

The device a range of 10m between itself and the SP2.



LCD Monitor Screen

AED MODE

Elapsed Time

Adult/Child Indicator

SP2 Battery Level

Heart Rate

Visual Guidance

Compression : Breaths Ratio

No. of Shocks Delivered

Energy Level

MANUAL MODE

'Manual Mode' Indicator

ECG Trace

Soft Key Indicators

MONITOR MODE

'Monitor Mode' Indicator

Bluetooth ECG Module Battery Status Indicator

Soft Key Indicator

SETUP MENU SCREEN

DEVICE SETUP	DATA REVIEW	EXIT
Device Mode		AED Mode
Manual Override		OFF
Adult / Pediatric Mode		Pediatric
Shock Energy		Fixed 150J
ECG Gain		10 mm / mV
Device Volume		1
Graphic Instructions		ON

DATA REVIEW SCREEN

DEVICE SETUP	DATA REVIEW	EXIT
	Power On	00:00:00
	Pads On	00:00:10
	Analyzing Heart Rhythm	00:00:10
	No Shock Advised	00:00:17
	Pause For CPR	00:00:20
	Pads On	00:00:53
	Pads On	00:00:57

i :EXIT
1 / 3

ECG PLAYBACK



Power Options

The SP2 provides both disposable and rechargeable battery options, with the disposable battery pack similar to the SP1, as well as a new rechargeable battery pack, designed for intensive usage of your machine. Along with the SP2, all the additional accessories; the Bluetooth printer and ECG transmission device both operate on rechargeable batteries.

The rechargeable battery pack is the recommended power option for when monitoring is required.

The SP2 Charging Dock provides a means to restore power to all your devices —in one sitting!

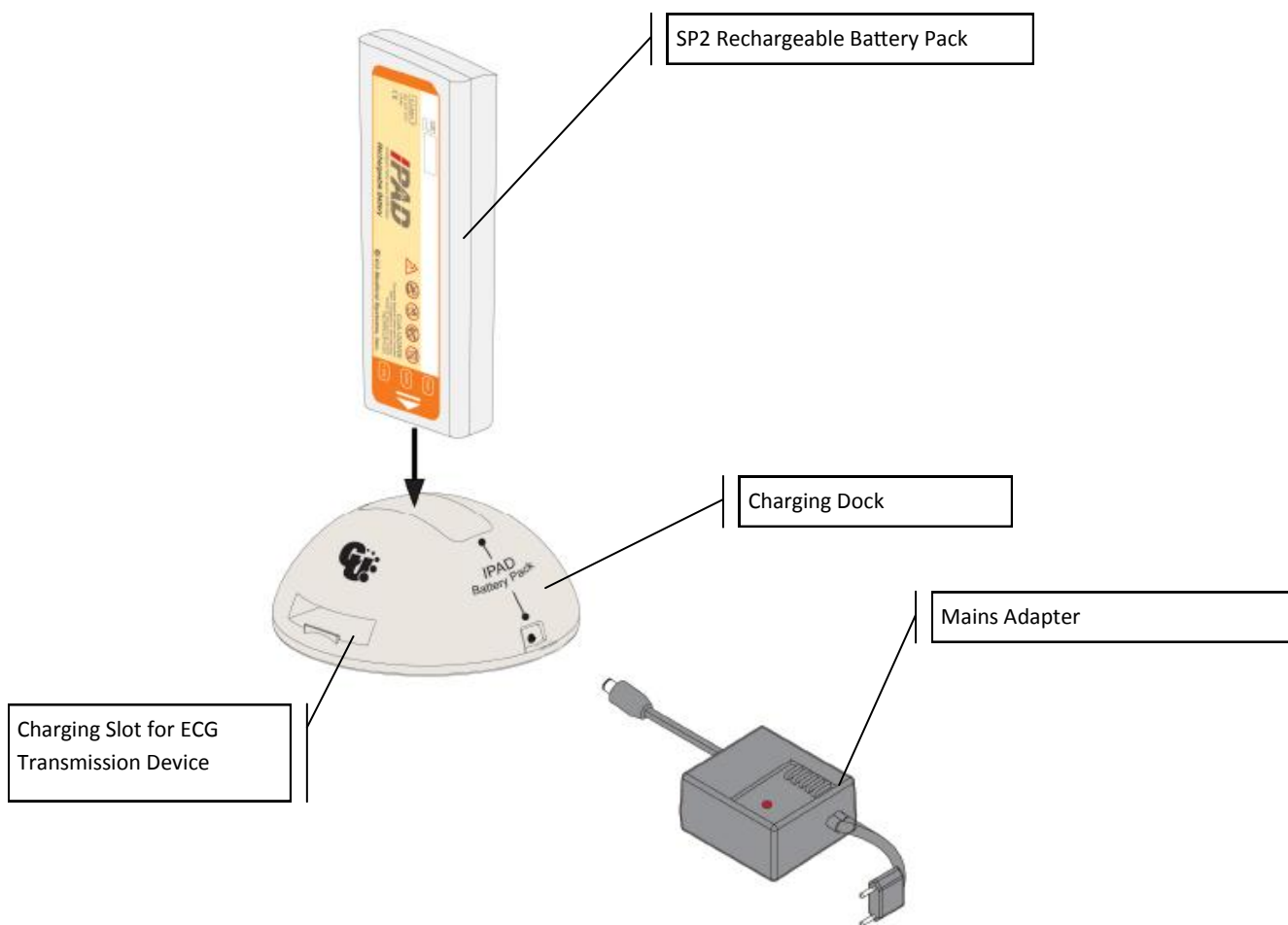

	Disposable Battery	Rechargeable Battery
Capacity	150 Shocks / 5 hours of operation time.	70 Shocks / 3 hours of operation time.



SP2 Accessories

Disposable Adult/Child Smart Electrode Pads

Adult/Child "Smart" Pads, capable of 'talking' to the device to notify users of expired defibrillator pads and if the pads have already been used.

These pads are useable with paediatric patients by simply selecting adult or child soft key. In AED mode, these pads can be used on infants down to 1 years old.



SP2 Battery Packs — Disposable and Rechargeable

See Power Options page for more details.

SP2 Orange Carry Case

This highly visible carry case is the perfect companion for your SP1 device. Currently available at no additional cost.

The bag has space for an additional set of pads, a spare battery, printer and ECG module. There is also a detachable shoulder strap.



Additional Options



Electrode Pad Adapters

These pad adapters will allow the electrode pads from Zoll, Phillips and PhysioControl to be used with the iPAD SP1.

This means the same pads can be unplugged from iPAD and plugged straight in to the defibrillator on the front line vehicle. This reduces risk, saves time, reduces trauma and is cost-effective.

Bluetooth 3 Lead ECG Monitoring

The 3-Lead ECH monitoring via bluetooth technology means patients can be continuously monitored, even in difficult environment or situations. It also means patients can be moved and monitored at all times.



Bluetooth Printer

This rechargeable printer using Bluetooth technology means that a full or partial print out can be obtained, on the scene during any scenario.

Recharged via a mains adapter.



Specifications

Dimensions 260_{mm} x 256_{mm} x 69.5_{mm} (Width x Length x Height)

Weight 2.4_{kg} (Including the battery pack and pads)

Environmental Conditions

Operating Environment (The device can be used immediately in case of an emergency.)

Temperature: 0°C ~ 43°C (32°F ~ 109°F)

Humidity: 5% ~ 95% (a location with no condensation)

Storage Environment (The device has pads and a battery and is ready to be used for an emergency.)

Temperature: 0°C ~ 43°C (32°F ~ 109°F)

Humidity: 5% ~ 95% (a location with no condensation)

Transportation Environment (The device does not have pads and a battery and is separately stored or transported over a long period of time.)

Temperature: -20°C ~ 60°C (-4°F ~ 140°F)

Humidity: 5% ~ 95% (a location with no condensation)

Altitude 0 to 15,000 feet (operational and storage)

Drop Withstands 1.2-meter drop to any edge, corner, or surface

Vibration Operating: Meets MIL-STD-810G

Sealing IEC 60529: IP55

ESD Meets IEC 61000-4-2:2001

EMI (Radiated) Meets IEC 60601-1-2 limits, method EN 55011:2007 +A2:2007,

Group 1, Class B

EMI (Immunity) Meets IEC 60601-1-2 limits, method EN 61000-4-3:2006 +A1:2008

Level 3 (10V/m 80MHz to 2500MHz)

Defibrillator

Operation Type Semi-automated External Defibrillator

Output Type e-cube biphasic (Truncated exponential type)

Output Energy - AED Mode

150J, 200J at 50Ω load for adults

50J at 50Ω load for children

- Manual Override (Not Option)

2J, 3J, 5J, 7J, 10J, 20J 30J 50J 70J, 100J, 150J, 200J

Charge Control Controlled by an automated patient analysis system

Charge Time For the first defibrillation of a new battery, capable of administering shock within 9 seconds of the given voice instruction.



Notes

WEL Medical Limited

Stableford House, Sebastopol Road, Aldershot, Hants. GU11 1SG.

Tel: 01252 344 007 | Fax: 01252 344 004 | Email: info@welmedical.com

www.welmedical.com | www.ipad-aed.com